

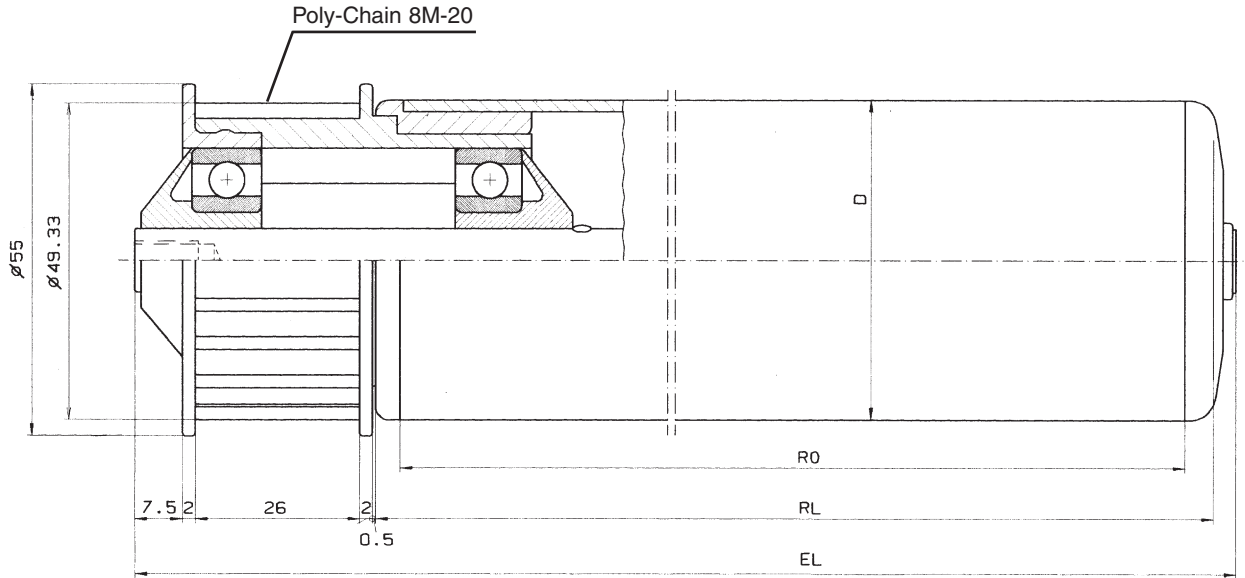

Conveyor Roller Type 445

Tube Ø 50, 60, 63, 63.5, 80



Order specification		A... M...	A... AGM...	A... IGM...	A... glatt	A... SW...	A... FA...
Shaft-Ø	EL =						
12	RL +	58		44			
14	RL +	60		44			
15	RL +	60		44			

The bearing fitting consists of a driving element 8 M z = 20 for tooth belt b = 12, made of thermoplastic synthetic material, and counter bearing.

Load capacity: max. 40 daN/roller

Type of tube: page I.3

Type of shaft: page I.4

Type of tooth belt: page IX.8

Special design:

Driving element steel Type 445 ST

Example how to order:

Type 445/300-50 x 1,5 STI A 12 IGM 8 EL ...

The type of drive, the bearing inside the driving element and the counter bearing provide the type of order.

Driving element	Type	Counter bearing
Accumulation drive with grooved ball-bearing 6202	445	250 / 300 / 302
Accumulation drive with grooved ball-bearing 6202 RS	445 RS	250 RS / 300 RS 302 RS 300 D / 302 D
Positive drive (pressfit) grooved ball-bearing 6202	446	250 / 300 / 302
Positive drive (pressfit) grooved ball-bearing 6202 RS	446 RS	250 RS / 300 RS 302 RS 300 D / 302 D